

**DETALHE 04**

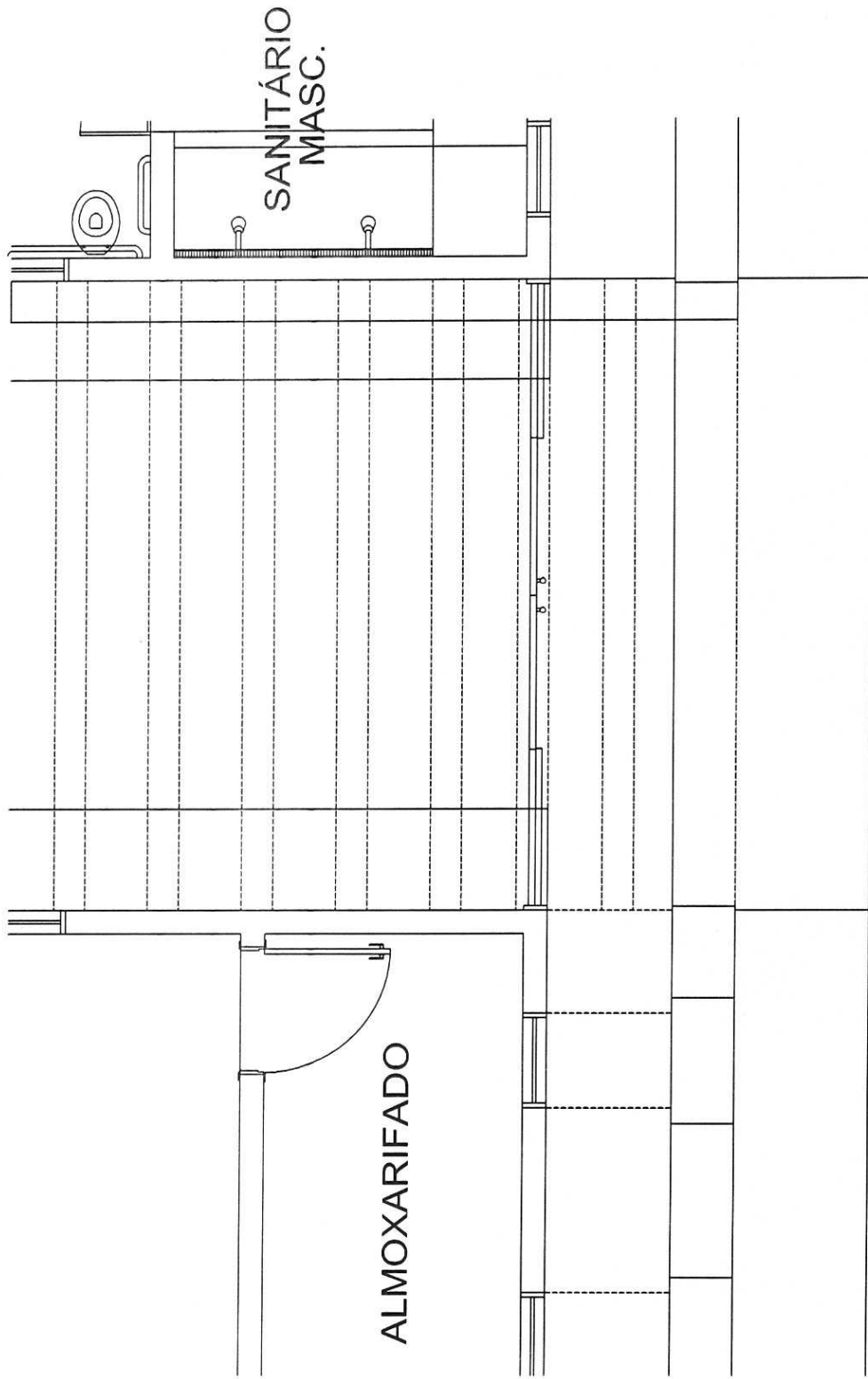

SANITÁRIO  
MASC.

ALMOXARIFADO

RAMPAS

ACESSO PÚBLICO



PLANTA BAIXA - DETALHE 04

*Adernanda*  
 MUNICÍPIO DE SERRA ALTA  
 Adernanda Paula dos Santos  
 Engenheira Civil  
 CREA/SC 112602-0  
 CPF: 064.471.419-08

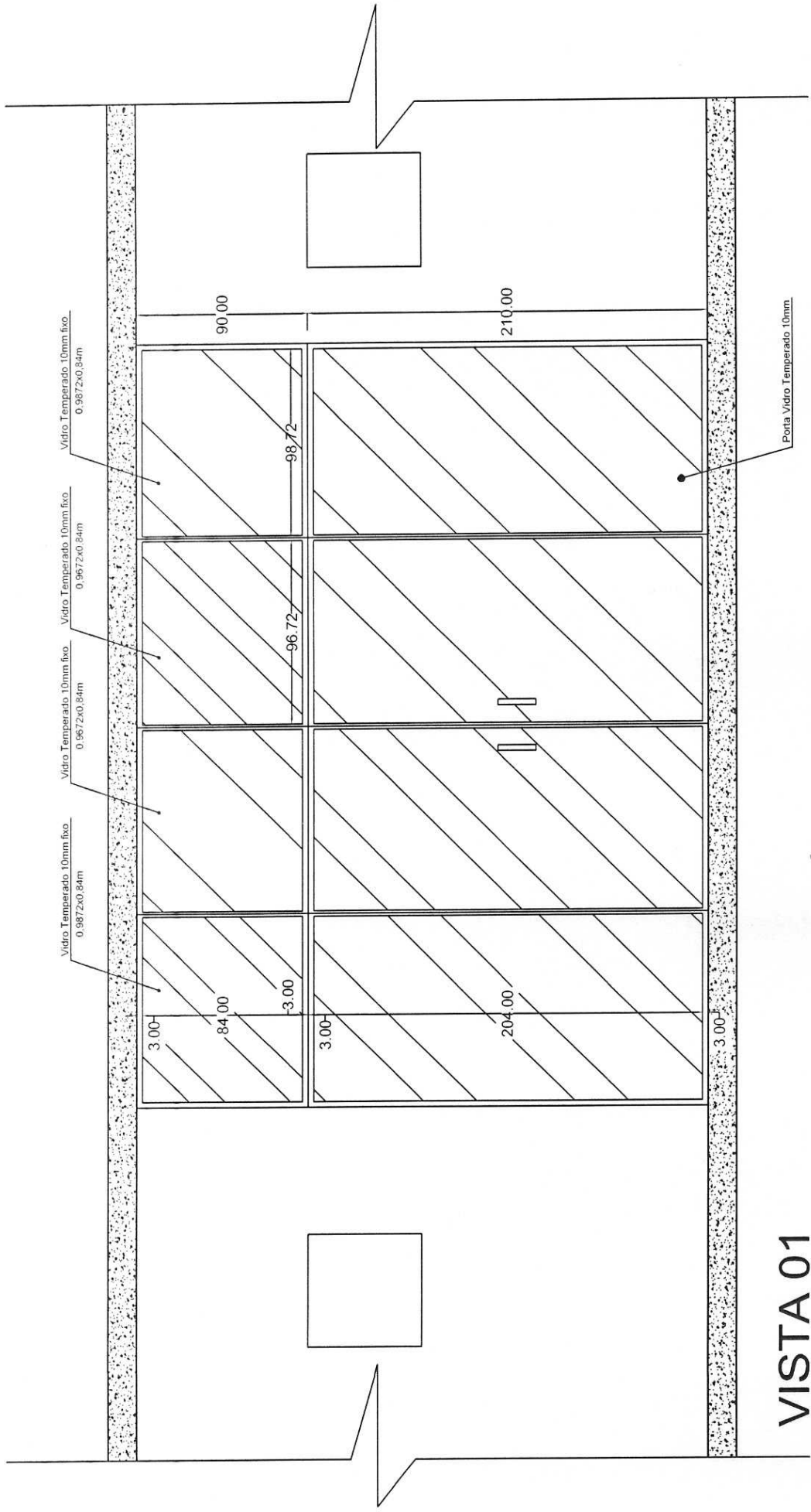

VISTA 01

*Adernanda*  
**MUNICÍPIO DE SERRA ALTA**  
**Adernanda Paula dos Santos**  
 Engenheira Civil  
 CREA/SC 112602-0  
 CPF: 064.471.419-08

*[Handwritten signature]*

COBERTURA INTERNA

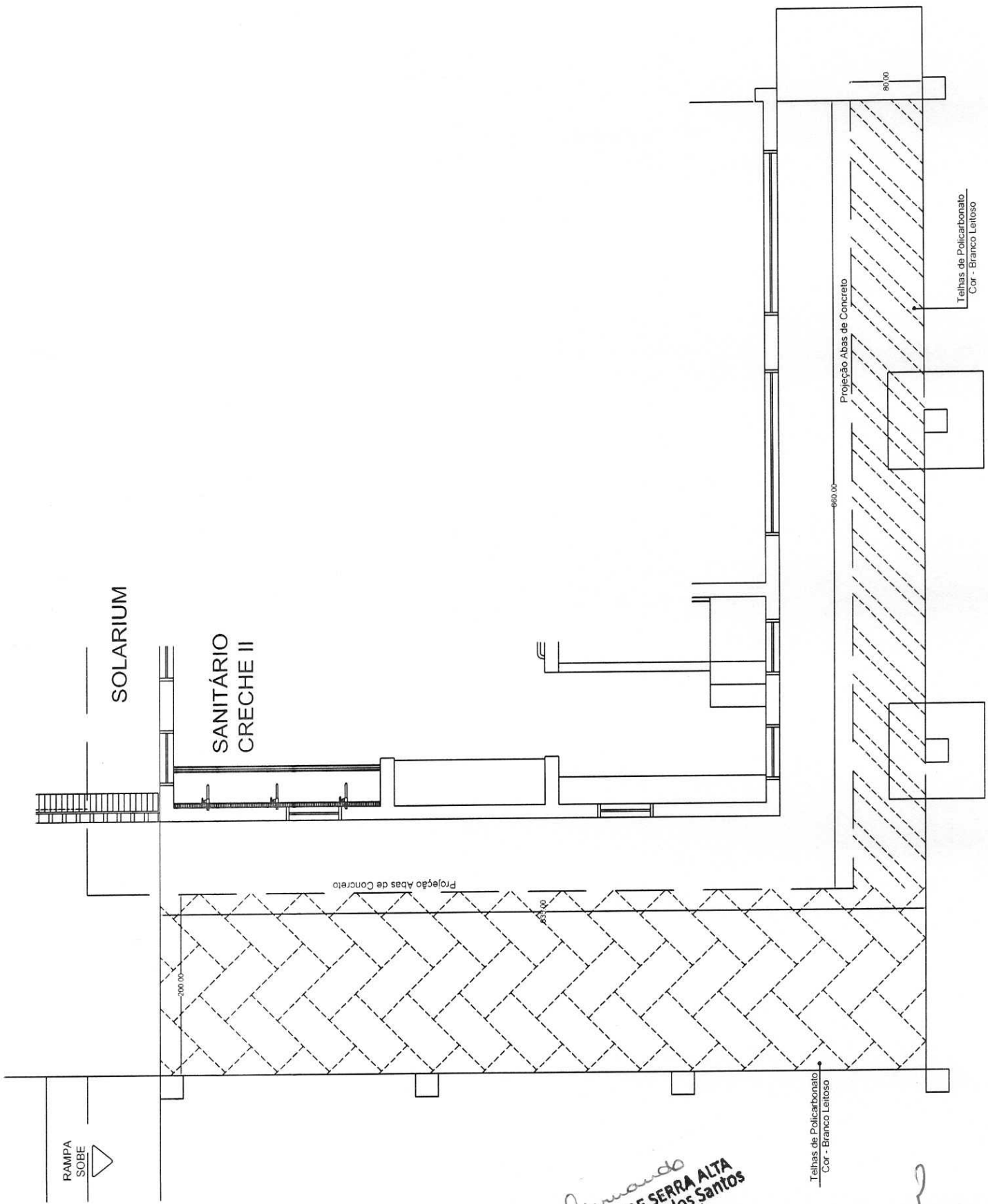

*Ademanda Paula dos Santos*  
**MUNICÍPIO DE SERRA ALTA**  
 Ademanda Paula dos Santos  
 Engenheira Civil  
 CREA/SC 112602-0  
 CPF: 064.471.419-08

*Ademanda Paula dos Santos*

C.I.-2  
(Existente)

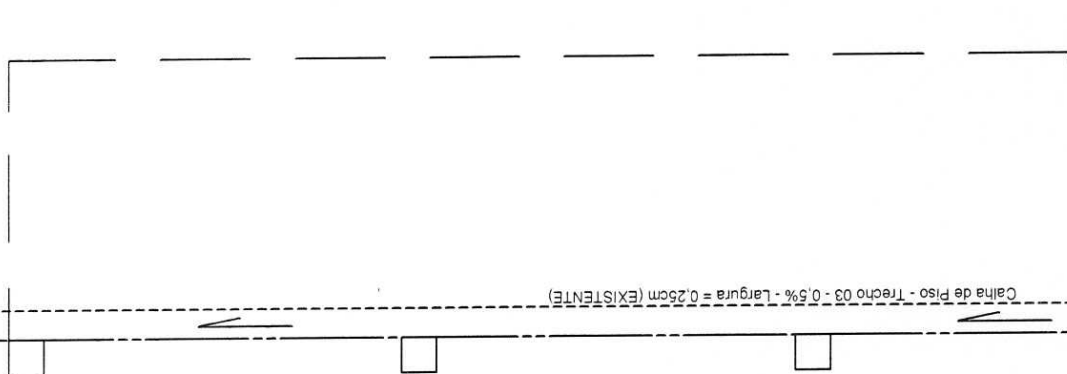

Calha de Piso - Trecho 03 - 0,5% - Largura = 0,26cm (EXISTENTE)

AP - 2  
DN - 100  
(Existente)

AP - 1  
DN - 50  
A Executar

OBS: Descida de 3,00m  
Deverá ser ligada a Calha  
de Piso existente

*Armando*  
MUNICÍPIO DE SERRA ALTA  
Aderianda Paula dos Santos  
Engenheira Civil  
CREA/SC 112602-0  
CPF: 064.471.419-08